

# Nuanced solutions to complex legal challenges



**Ingenuity,  
thoughtfulness +  
insight**

# Our Focus

**Serving clients in today's complex and rapidly changing world requires attorneys with local knowledge, regional vision and the ability to problem-solve at a national level.**

Our foundation is local, and we enjoy enduring ties to leaders, institutions and decision-makers and have vast experience in the courts in the communities we serve. Over 45 years, we have established ourselves as the leading law firm serving a vast region that includes Westchester, New York City, Connecticut and the Hudson Valley. We take pride in our efforts on behalf of many clients and projects that have played a significant role in the region's emergence as a business and cultural center, with transformed skylines and vibrant communities with rich quality of life. And our attorneys are well prepared to help our clients thrive in the coming years, building on this strong foundation to achieve the region's next generation of prosperity and growth.





**Knowledge and experience rooted at the local level, a robust regional network, and powered by our understanding of the latest national trends – that’s the foundation on which we built our practice.**

## Our Commitment

---

In 45 years, Cuddy & Feder has grown from a two-man team operating out of a three-story colonial house on Maple Avenue in White Plains, NY, to a firm of 40 professionals with four offices throughout the region, from Midtown Manhattan, up to the Hudson Valley, and throughout the state of Connecticut. Needless to say, these 45 years have been a period of incredible growth, both for our firm and the communities we serve.

Despite these changes, the warm, welcoming family feel of the firm remains the same. As a mid-sized firm, we believe our size and commitment to diversity are invaluable strategic assets. It allows us to maintain the highest level of personal service to our clients while also ensuring that we meet our clients' needs through seamless teamwork, which is made possible through our multi-disciplined practice.

**At Cuddy & Feder, we also pride ourselves on maintaining deep substantive ties to the communities we serve. Our civic involvement straddles both our personal and professional lives in a way that gives us a unique understanding of the issues and challenges endemic to our communities.**

Whether through pro bono representation, charitable contributions, volunteer board service, or donation of our time, our attorneys and staff uphold the values of the firm and demonstrate our everyday commitment to the many organizations, associations and institutions that do so much to enhance the quality of life and the cultural and economic character of our region.

**Our goal is to approach projects as a win-win opportunity for the entire community.**



Enriching our communities through creative redevelopment by finding the best new use for what's already there.



---

We meet our clients' needs through teamwork, made possible by our multi-disciplined practice groups.

---



**Being a mid-sized firm is an invaluable strategic asset. It allows us to serve clients as part of a seamless team.**



---

We are committed  
to providing our clients  
with the highest level of  
personal service.

---



**valuable**  
**serve our**  
**am.**

---

The single most important  
factor that drives our success  
as a firm is our people.

---

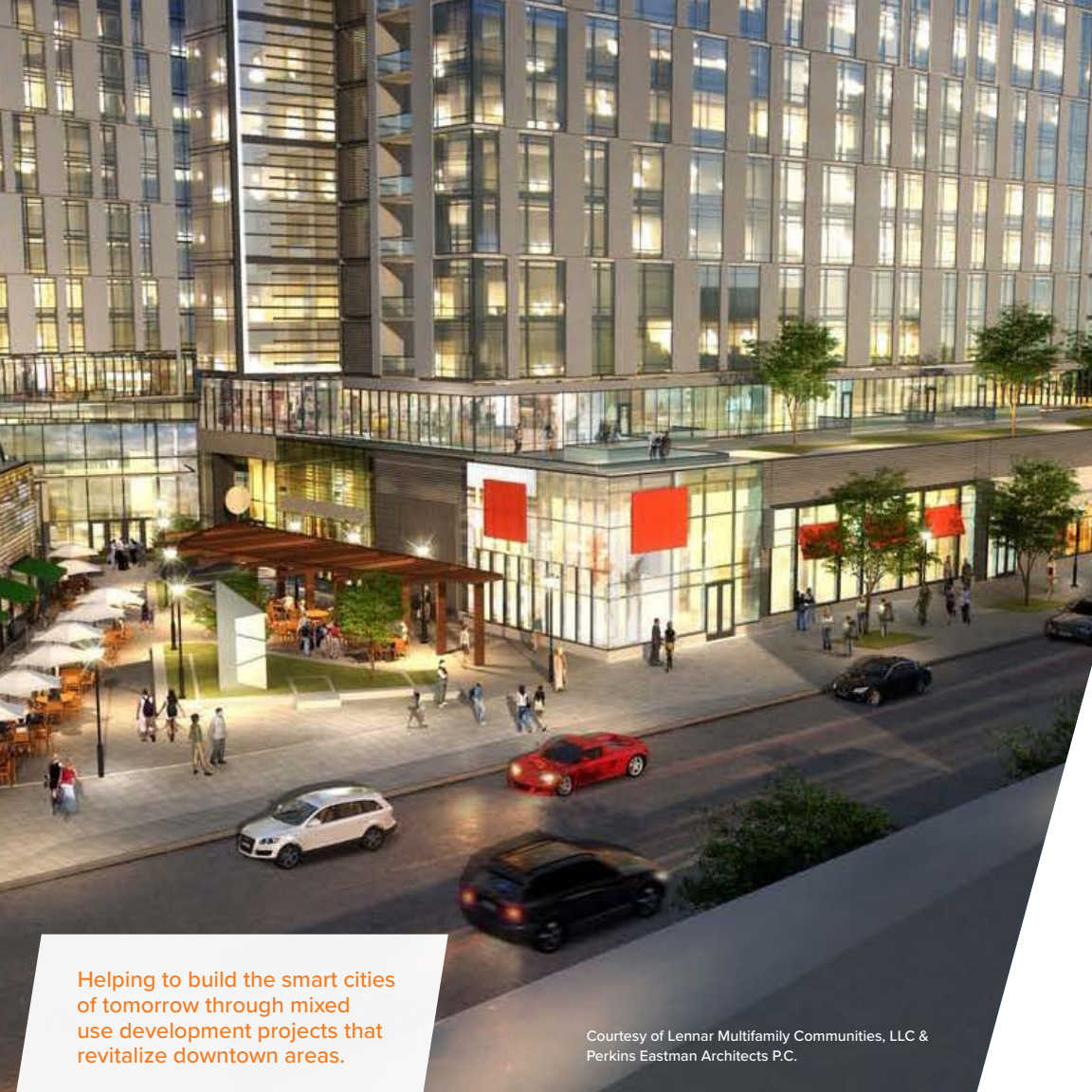

Helping to build the smart cities of tomorrow through mixed use development projects that revitalize downtown areas.

Courtesy of Lennar Multifamily Communities, LLC & Perkins Eastman Architects P.C.





## Our Method

---

Ingenuity, thoughtfulness and insight have been the hallmarks of our approach to legal practice for more than 45 years. We pride ourselves on our reputation for the quality, caliber and cost-effectiveness of our work, bringing deep industry knowledge, compassion and experience to bear on behalf of our clients. Handling a wide range of matters, from real estate, complex financing transactions and land use & zoning to estate planning and litigation, we begin each assignment the same way – by listening carefully to our client’s objectives – and only then do we craft a legal strategy based on understanding our client’s needs, budget and goals.

Our approach is straightforward, as we avoid over-complicating a problem and over-lawyering the solution. But when the situation calls for it, as with a major real estate development, or complex litigation, we are fully prepared to offer strategic vision and team leadership that are necessary to help guide the matter to successful completion.

**Sometimes deals don’t go the way you expect, and that’s when it’s most important to have Cuddy & Feder’s full service team of land use, finance and litigation attorneys ready to step in.**

## Our Knowledge

---

Cuddy & Feder attorneys are routinely recognized for their contributions to the legal arena and collectively are considered thought leaders in their respective fields. Many of our attorneys are not only accomplished legal professionals, but have come to the legal profession with strong backgrounds in their respective fields, with the industry knowledge from the perspective of clients. Cuddy & Feder attorneys have headed bar associations, helmed influential trade organizations, published important legal and industry articles, lectured throughout the country, and regularly appear nationally and regionally as commentators on legal matters. As a firm, Cuddy & Feder is listed among U.S. News' list of Best Law Firms.



Enhancing the quality of life and the cultural and economic character of our region through our work with leading institutions.

# Practices

**Corporate**

**Energy + Environmental**

**Finance**

**Land Use, Zoning + Development**

**Litigation**

**Non-Profit Organizations**

**Real Estate**

**Telecommunications**

**Trusts, Estates + Elder Law**



# Contact Us

Headquartered in White Plains, New York, Cuddy & Feder currently represents a broad array of clients, with offices in Westchester, the Hudson Valley, New York City and Stamford, Connecticut, meeting the needs of our clients, wherever they may be.

## Westchester

445 Hamilton Avenue  
14th Floor  
White Plains, NY 10601  
T 914.761.1300  
F 914.761.5372

## New York City

500 Fifth Avenue  
Suite 1600  
New York, NY 10110  
T 212.944.2841  
F 212.944.2843

## Hudson Valley

300 Westage  
Business Center  
Suite 380  
Fishkill, NY 12524  
T 845.896.2229  
F 845.896.3672

## Connecticut

733 Summer Street  
Stamford, CT 06901  
T 203.969.9060

[cuddyfeder.com](http://cuddyfeder.com)



[linkedin.com/company/cuddy-&-feder-llp](https://www.linkedin.com/company/cuddy-&-feder-llp)



[twitter.com/CuddyFeder](https://twitter.com/CuddyFeder)